

# Square Drive Lever Control Ratchets

Premium ratchets from Cementex are available in multiple styles to match the new designs and developments of the Insulated Ratchet. Whether you are looking for an entirely new, state of the art design, or you are looking to update and replace tools from a set already in service, Cementex has the ratchet to keep you safe.



IR38-LCS

IR14-LC

IR34-LC

The “Classic” Regular Profile Short Drive Ratchet has been the industry standard design, set by Cementex, for decades. This ratchet features precision geared design which provides minimal distance between gear engagement and allows better control in tight spaces.

*The “Classic” is the standard ratchet included in Cementex 1/4” Drive Sets.*

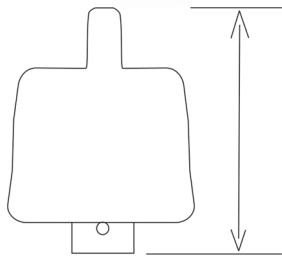

**Regular Profile  
Short Drive**

1/4” Dr. = 1.60”  
3/8” Dr. = 2.30”  
1/2” Dr. = 2.20”

Regular Profile Short Drive Options	
Part Number	Description
IR14-LC	1/4” Square Drive Ratchet
IR14-LCS	1/4” Square Drive “Stubby” Ratchet
IR38-LCSD	3/8” Square Drive Short Drive Ratchet
IR12-LCSD	1/2” Square Drive Short Drive Ratchet
IR34-LC	3/4” Square Drive Ratchet

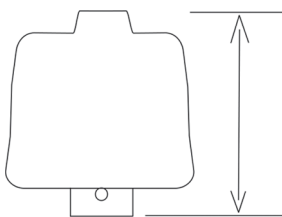

**Low Profile  
Short Drive**

1/4” Dr. = 1.30”  
3/8” Dr. = 2.00”  
1/2” Dr. = n/a



IR38-LCLPSD

The Low Profile Short Drive Ratchet from Cementex is the “Classic” but with a shorter lever control. This shorter lever control reduces the head height and may allow the use of a ratchet where clearance may otherwise make it impossible.

Low Profile Short Drive Options	
Part Number	Description
IR14-LCLP	1/4” Square Drive Low Profile Ratchet
IR38-LCLPSD	3/8” Square Drive Short Drive Low Profile Ratchet
IR12-LCLPSD	1/2” Square Drive Short Drive Low Profile Ratchet



IR38-LC



The Cementex X-Drive® revolutionized the Insulated Ratchet and the method of concealing connection points between ratchets, extensions, adapters, and sockets. X-Drive® ratchets feature an extended drive, designed to mate with Cementex “Booted” interchangeable tools. When X-Drive® connections are made an overlap of insulation is created between components, providing a completely concealed connection. This connection is cleaner, slimmer reduces the potential of damage to sockets and extension insulation.

*X-Drive® is the standard ratchet included in Cementex 3/8” and 1/2” Drive Sets.*

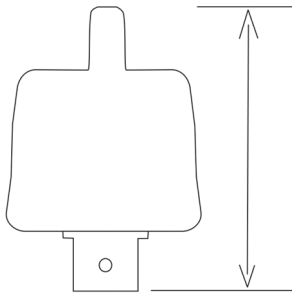

**Regular Profile  
Cementex X-Drive®**

1/4” Dr. = n/a  
3/8” Dr. = 2.60”  
1/2” Dr. = 3.00”

**Regular Profile Cementex X-Drive® Options**

Part Number	Description
IR38-LC	3/8” Square X-Drive® Ratchet
IR38-LCS	3/8” Square X-Drive® “Stubby” Ratchet
IR38-LCLP	3/8” Square X-Drive® Low Profile Ratchet
IR12-LC	1/2” Square X-Drive® Ratchet
IR12-LCS	1/2” Square X-Drive® “Stubby” Ratchet

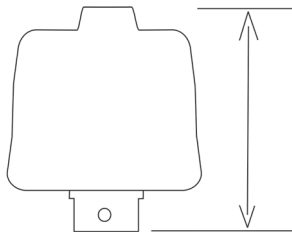

**Low Profile  
Cementex X-Drive®**

1/4” Dr. = n/a  
3/8” Dr. = 2.30”  
1/2” Dr. = 2.60”

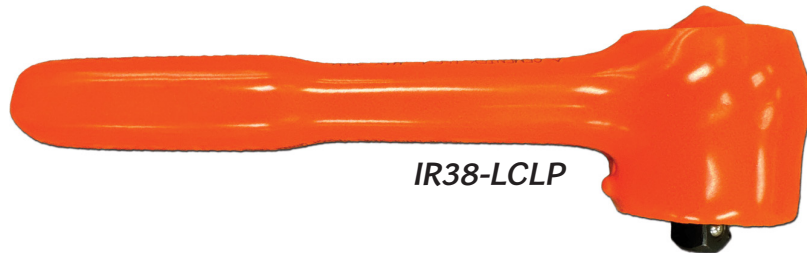

IR38-LCLP

The Low Profile X-Drive® Ratchet from Cementex features a shorter lever control. This shorter lever control reduces the head height and may allow the use of a ratchet where clearance may otherwise make it impossible.

**Low Profile Cementex X-Drive® Options**

Part Number	Description
IR38-LCLP	3/8” Square X-Drive® Low Profile Ratchet
IR12-LCLP	1/2” Square X-Drive® Low Profile Ratchet

Cementex double-insulated tools:

- Comply with the IEC 60900 standard
- Comply with ASTM F1505 standard
- Help you meet the requirements of OSHA Safety Related Work Practices, NFPA 70E Standard and CSA-Z462

Cementex double-insulated tools are:

- Tested to 10,000 VAC and rated for 1,000 VAC/1,500DC when working on live parts
- Manufactured in the U.S.A. with both US and globally sourced materials
- Marked with the international safety symbol —  1000V

